

PFPD

Installation

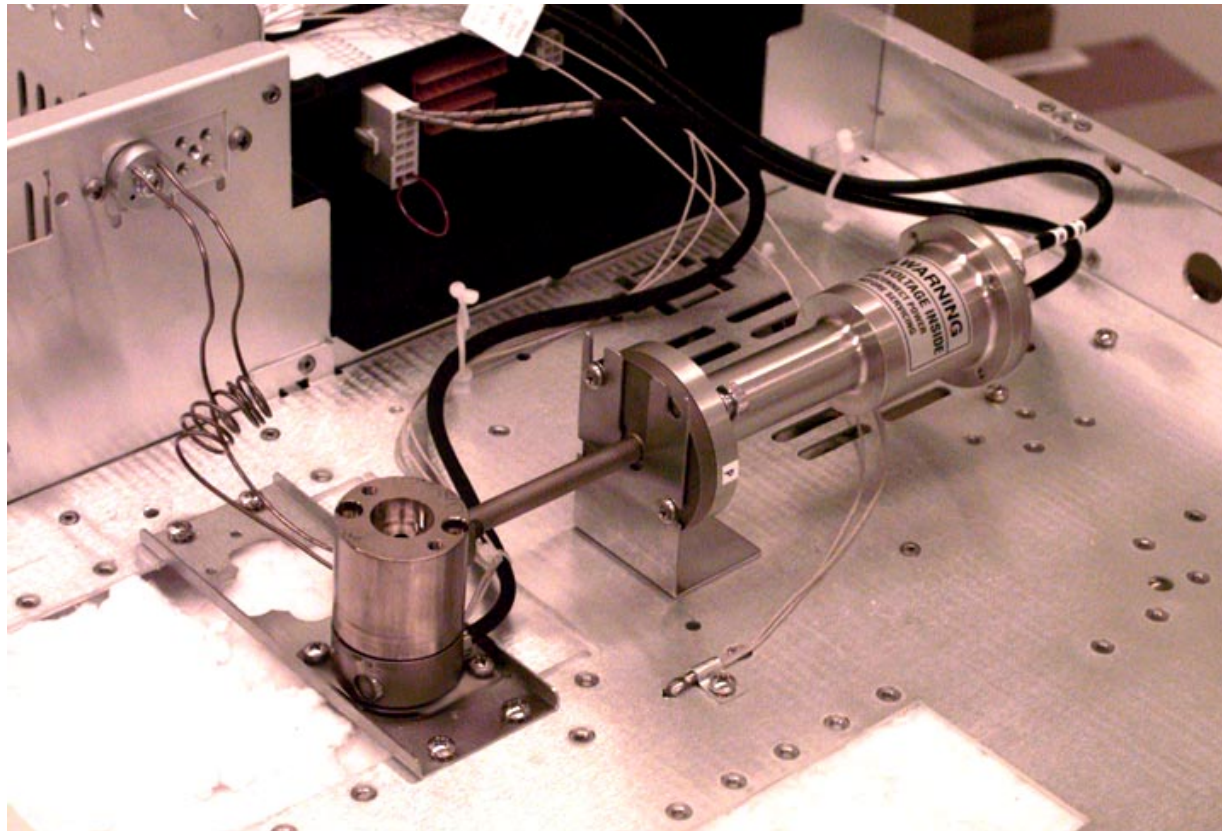

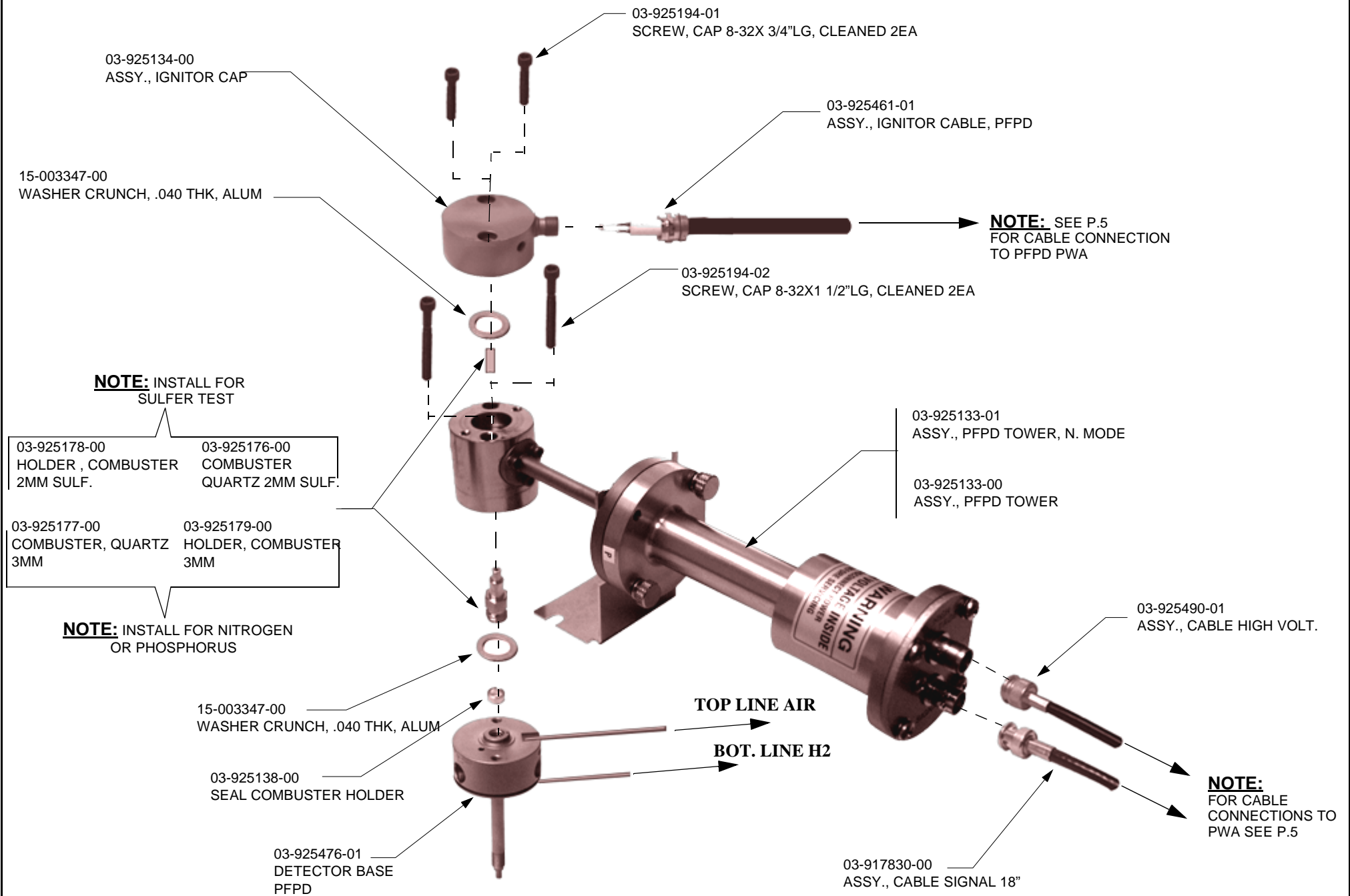

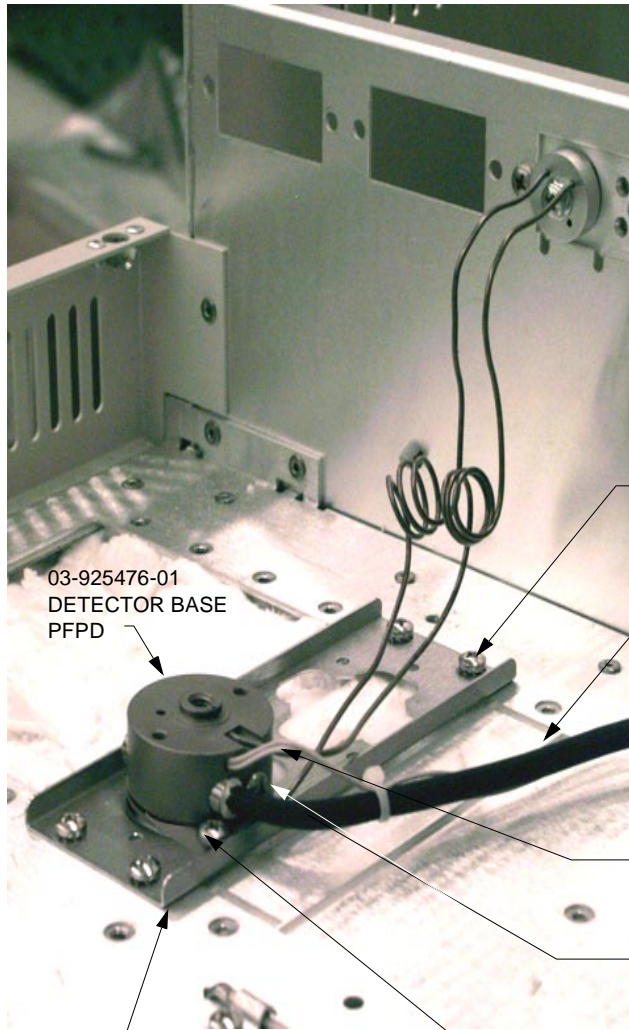

12-901163-00
SCREW, 4EA

03-925396-01
120V HTR. ION

03-925396-02
220V HTR. ION

03-925396-03
101V HTR. ION

03-925374-01
TEMPERATURE PROBE

12-901165-00
SCREW

12-901163-00
SCREW, 2EA

-03-925526-01
DETECTOR BASE CLIP

03-925326-01
DETECTOR MOUNTING BASE

03-925476-01
DETECTOR BASE
PFPD

[CLICK HERE FOR
HEATER CONNECTION
J41 ON POWER BOARD](#)

[CLICK HERE
FOR PROBE
CONNECTION TO
J7 ON MAIN BD.](#)

03-917142-00
VITON FERRULE REF. ONLY

12-901150-00
SCREW

03-917141-00
CONDYNE PLATE

REF.
ONLY

H2 BOTTOM
LINE FROM
DET. BASE,
RED\BLACK\CLEAR

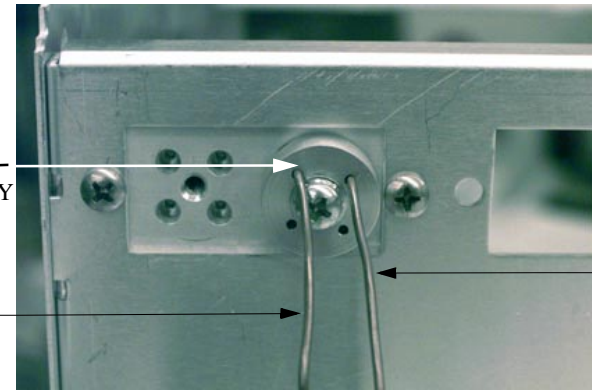

AIR TOP
LINE FROM
DET. BASE,
BLACK\RED

DETECTOR SIDE MANIFOLD

[CLICK HERE OR
ON PICTURE TO
SEE S/A OF PFPD](#)

03-925133-01
ASSY., PFPD TOWER, N. MODE
OR
03-925133-00
ASSY., PFPD TOWER

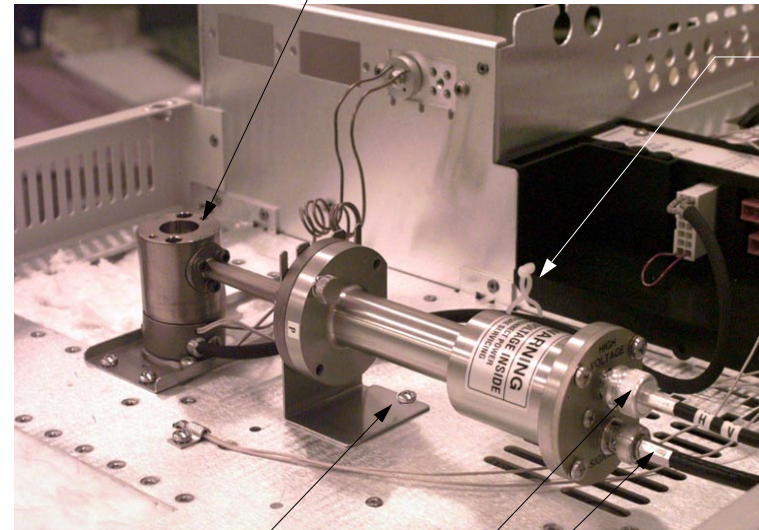

22-300000-00
STANDOFF WIRE
TIE

12-901165-00
SCREW, SEMS, 8-32
1/4" LG. EXT., SST

03-925490-01
ASSY., CABLE HIGH
VOLT., 34" LG.

03-917830-00
ASSY., CABLE SIGNAL 18"

16-000589-00
1/16" TEE TUBE, SST

03-918853-13
PEEK TUBING , ORANGE
30"LG

03-918853-02
PEEK TUBING , BEIGH

03-918853-02
PEEK TUBING ,
NATURAL

BEIGH\BLK\BLK

RED\CLR\BLK

FROM MANIFOLD

03-918853-02
PEEK TUBING ,
NATURAL, H2
INLET

03-918959-01
FILTER, FLOW MODULE

03-918853-02
PEEK TUBING , NATURAL, H2

27-180166-00
CHECK VALVE

03-917146-03
FLOW CONTROLLER, 25CC/MIN

57-000028-00
NEEDLE VALVE

03-918853-05
PEEK TUBING , RED, H2

03-918853-05
PEEK TUBING , RED, H2

03-917146-04
FLOW CONTROLLER,
60CC/MIN. 2EA

03-918853-06
PEEK TUBING , BLACK, AIR

03-918853-05
PEEK TUBING , RED, H2

03-917147-00
ASSY., CONNECTOR W/
FRIT 3EA

28-691944-00
TEE, 1/8 TUBE ,BRASS 4EA

03-918853-06
PEEK TUBING , BLACK, AIR

03-918853-06
PEEK TUBING , BLACK, AIR INLET

27-180166-00
CHECK VALVE

NOTE:
AT BOTH ENDS OF ALL
PEEK TUBING USE:

- 03-917157-00
WASHER, FERRULE CLEANED 23EA
- 03-917084-00
VITON FERR., NUT 23EA.
- 03-917142-00
VITON FERRULE 23EA.

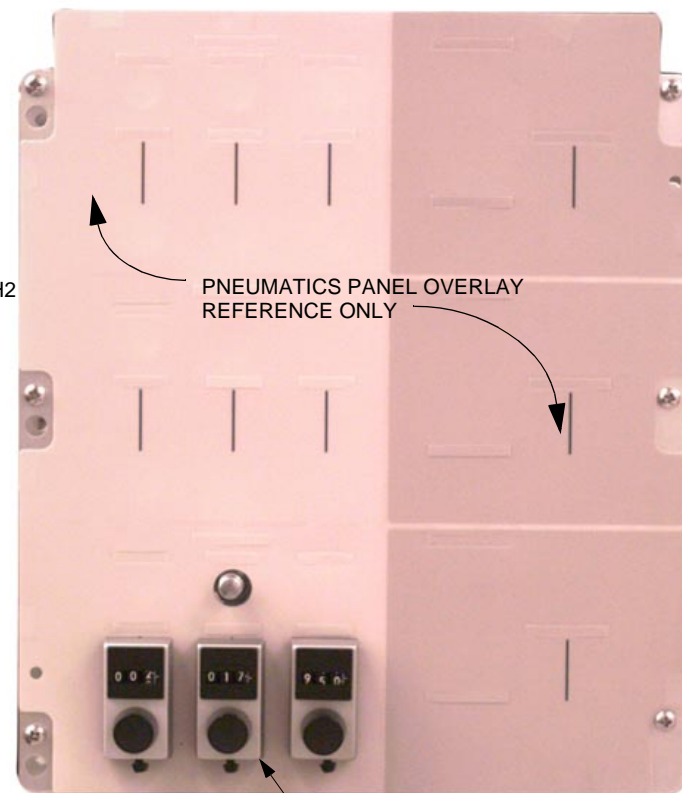

PNEUMATICS PANEL OVERLAY
REFERENCE ONLY

23-599813-00
DIAL, TURNS COUNTER 3EA

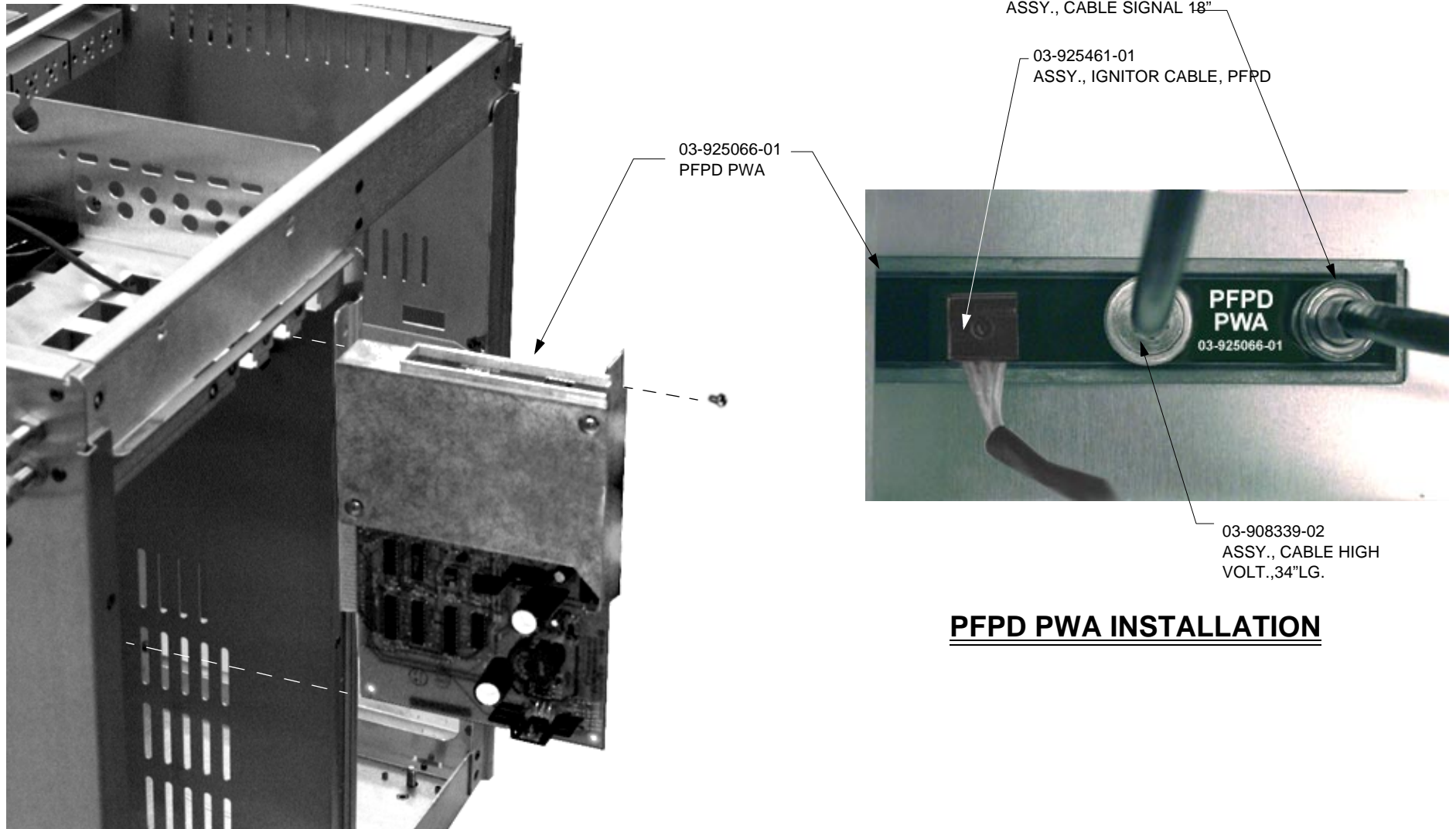

PFPD PWA INSTALLATION